



WINDOW & FACADE

COMPACT VERTICAL AWNING WITH ROUND PROTECTIVE BOX



UNIVERSAL US3910



Wire rope guides



Rod guides



Guide rails

- Compact box system with round protective box
- Mounting options on to the wall, below the ceiling or in the soffit
- Various guide systems: Wire rope, rods or aluminium profile
- Elegant system for use before glass fronts or roofed terraces
- Manual operation through the wall possible using gear unit/joint plate
- Coupling options for max. 3 units

US3910



min. 1' 4"
max. 14' 9"



min. 1' 4"
max. 13' 1"*

* with cable/rod design to max. 9' 10" high



Technical dimensions in millimetres (1 mm = 0.03937")

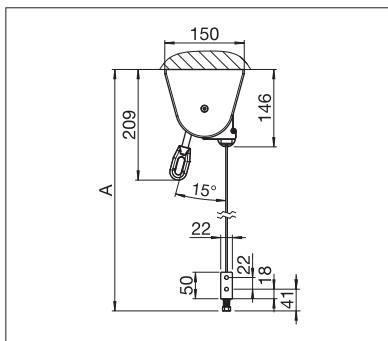

US3910 Top installation

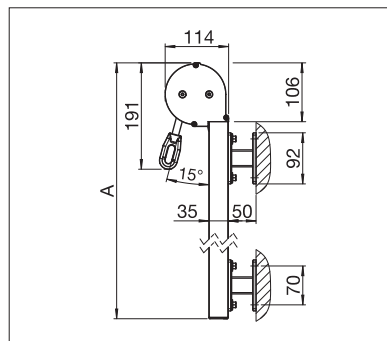

US3910 Offset wall mounting



COLORS

Discover the diverse options when selecting frame colors.



FABRICS

Choose from a comprehensive range of materials and colors.



ELECTRICS

More convenience thanks to the automated control.